

LOC	QTY	REV	ZONE	LTR	DESCRIPTION	DATE	APPD
G	14				REVISED PER 0720-0230-93	2/25/94	AMP

METRIC
DIMENSIONS LISTED IN mm [INCHES]

AMP WIRE RANGE	IL E13288 Listed
22-16 AWG STRANDED	22-16 AWG STRANDED
LR7189 Certified	MILITARY P/N AND CLASS
NOT CERTIFIED	NOT APPLICABLE

△ STAMP AMP 22-18* APPROX AS SHOWN
22-16 TERMINALS ARE STAMPED 22-18 IN
ACCORDANCE WITH MILITARY SPECIFICATION
MIL-T-7928, COMMERCIAL WIRE RANGE IS 22-16

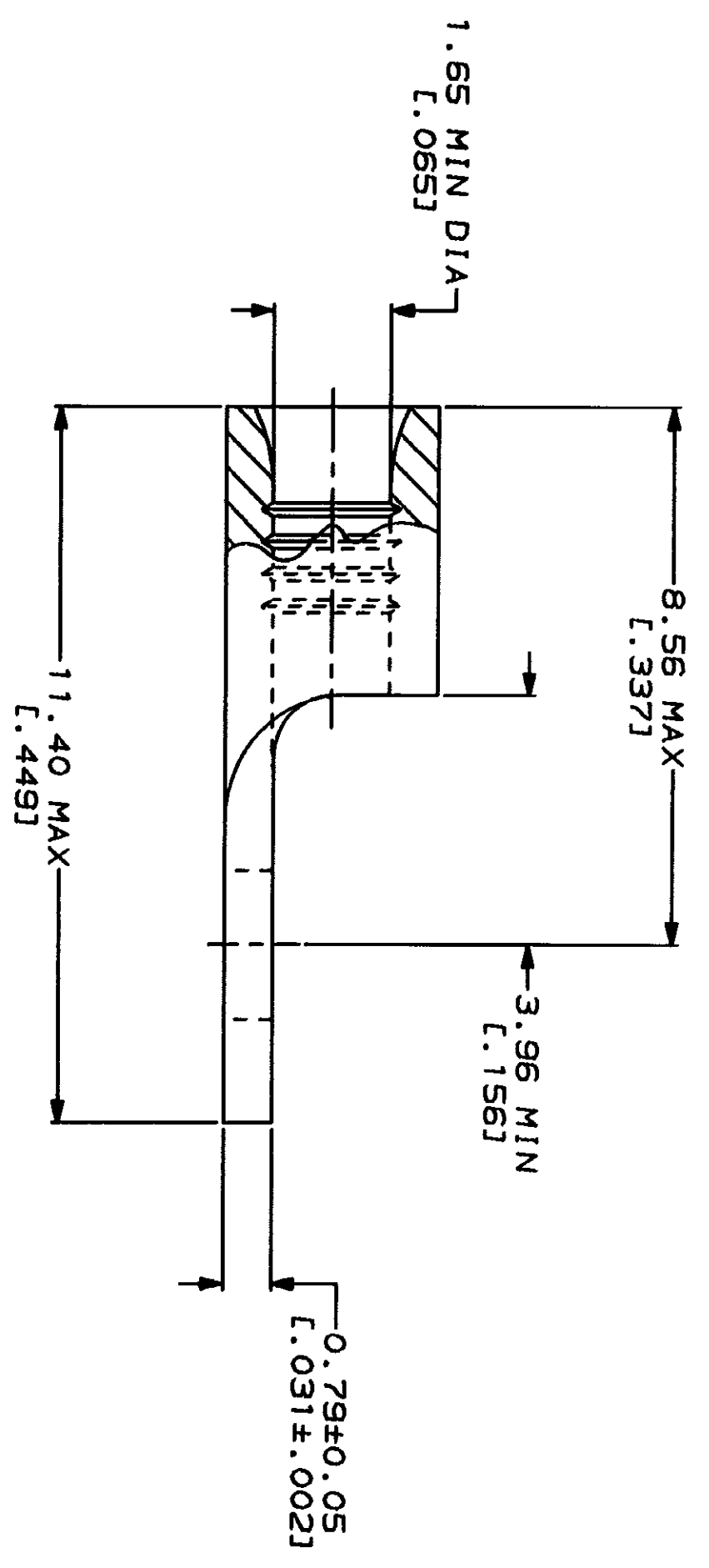
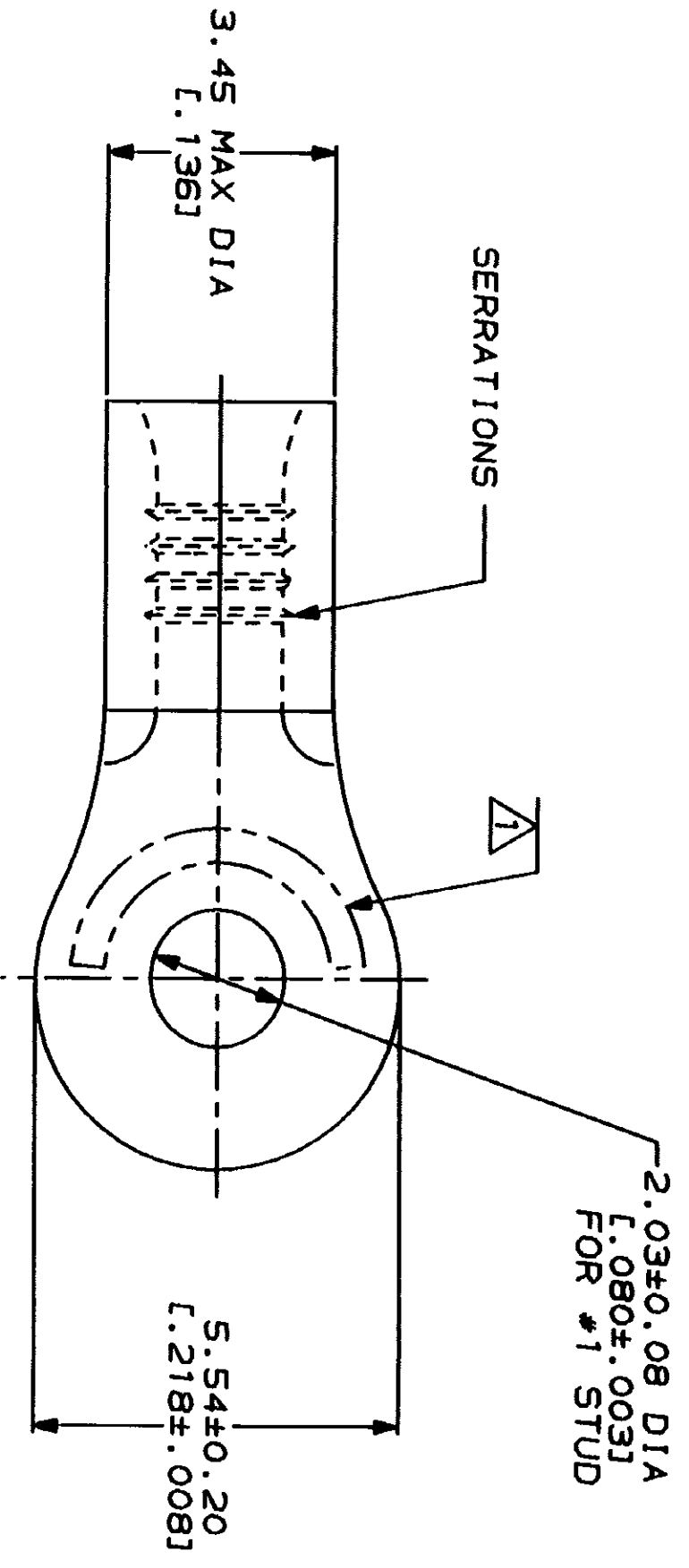

AMP INCORPORATED
CUSTOMER SERVICE SYSTEMS

FOR ADDITIONAL
PRODUCT INFORMATION OR
COPIES OF DRAWINGS
AND TECHNICAL DOCUMENTS
1-800-522-6752
PRODUCT INFORMATION CENTER

FOR APPLICATION
TOOLING INFORMATION
1-800-722-1111
TOOLING ASSISTANCE CENTER

FOR ORDER ENTRY
1-800-526-5142

MAX RECOMMENDED OPERATING
TEMPERATURE: 170°C MAX

VOLTAGE RATING:
NOT APPLICABLE

WIRE CROSS SECTIONAL AREA RANGE:
0.26-1.65mm² [509-3,260] CIR MILS
STRANDED

DO NOT SCALE PRINT.
DIMENSIONS SPECIFIED IN INCHES—
TOLERANCES ON:
2 PLC DEC ± .01
3 PLC DEC ± .005
ANGLES
MATERIAL
COPPER PER
ASTM B-152
ANNEALED

DR 1-27-93 TA BRINKMAN	NAME AMP AMP Incorporated Harrisburg, PA 17105-3608
CHK 1-27-93 DA PATTERSON	TERMINAL, RING TONGUE, BUDGET
APPD 1-27-93 DE MILLER	SIZE CAGE CODE DRAWING NO
APPD 1-27-93 JL HECKLEY	00779 G-31087
PRODUCT SPEC	SCALE 10:1
APPLICATION SPEC	SHEET 1 OF 1
FINISH TIN PLATE 0.00254[L.000100] MIN THK PER MIL-T-10727	PART NO 31087